

static seal R20-P

seal spec

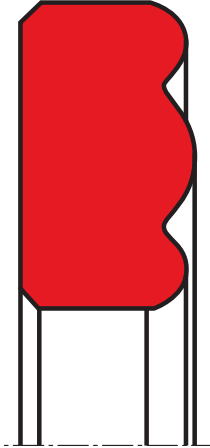

description

flange seal for static applications, suitable for high pressure range. direction of pressurization (from inside or outside) must be indicated when ordering the seal.

application



category of profile

machined only.

operating parameters & materials

diameter range: up to 600 mm

material	temperature	max. surface speed	max. pressure ¹
s-mart PU	-30 °C ... +110 °C	-	800 bar (80 MPa)
s-mart HPU	-20 °C ... +110 °C	-	800 bar (80 MPa)
s-mart SPU	-20 °C ... +110 °C	-	800 bar (80 MPa)
s-mart LTPU	-50 °C ... +110 °C	-	800 bar (80 MPa)
s-mart GPU	-30 °C ... +110 °C	-	800 bar (80 MPa)

the stated operation conditions represent general indications. it is recommended not to use all maximum values simultaneously.

surface speed limits apply only to the presence of adequate lubrication film.

¹ pressure ratings are dependent on the size of the extrusion gap.

surface quality

	Rtmax (µm)	Ra (µm)
surface roughness	≤10	≤1,6

tolerance recommendation

seal housing tolerances

Ød	h10
ØD	H10



seal & housing recommendations

please note that we are able to produce those profiles to your specific need or any non standard housing. for detail measurements, please see seal-mart catalog...

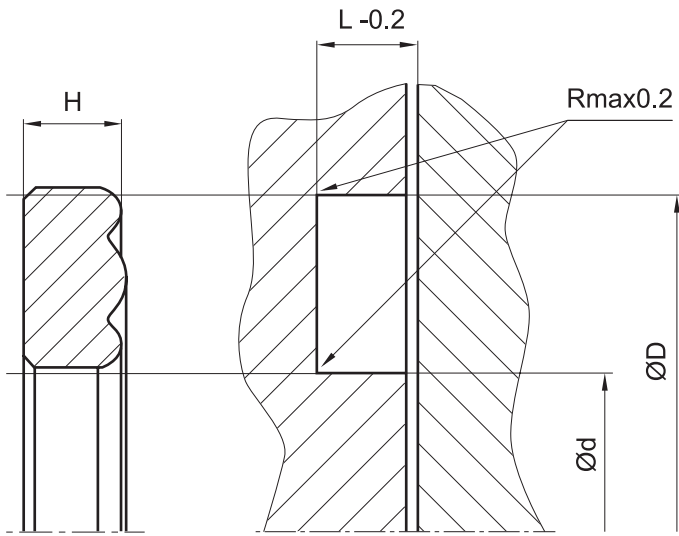

don't hesitate to contact our technical department for further information or for special requirements (temperature, speed etc.), so that suitable materials and/or designs can be recommended.